

SƠ ĐỒ ĐỊNH HƯỚNG KHÔNG GIAN KIẾN TRÚC CẢNH QUAN

STT	Chức năng đất	Ký hiệu	Diện tích (%)	Số lô	MĐXD tối đa (%)	Tầng cao nhất	Hệ số sử dụng đất	Tỷ lệ (%)
I	Đất ở	17026,55	127					40,93
I.1	Đất nhà ở liên kết	12718,64	111					30,58
	Đất nhà ở liên kết 1							
	LK-01	715,52	66	5	4,05			
	LK-01-01	142,62	81,0	5	4,50			
	LK-01-02	100,00	90,0	5	4,50			
	LK-01-03	100,00	90,0	5	4,50			
	LK-01-04	112,96	87,0	5	4,34			
	LK-01-05	112,96	87,0	5	4,35			
	LK-01-06	100,00	90,0	5	4,50			
	LK-01-07	100,00	90,0	5	4,50			
	LK-01-08	125,73	85,0	5	4,25			
	LK-01-09	128,52	84,0	5	4,20			
	LK-01-10	100,00	90,0	5	4,50			
	LK-01-11	100,00	90,0	5	4,50			
	LK-01-12	107,00	89,0	5	4,45			
	LK-01-13	107,04	89,0	5	4,45			
	LK-01-14	100,00	90,0	5	4,50			
	LK-01-15	100,00	90,0	5	4,50			
	LK-01-16	125,81	85,0	5	4,25			
	LK-01-17	125,74	85,0	5	4,25			
	LK-01-18	100,00	90,0	5	4,50			
	LK-01-19	100,00	90,0	5	4,50			
	LK-01-20	112,88	87,0	5	4,35			
	LK-01-21	112,88	87,0	5	4,35			
	LK-01-22	100,00	90,0	5	4,50			
	LK-01-23	100,00	90,0	5	4,50			
	LK-01-24	115,82	87,0	5	4,35			
	LK-01-25	125,80	85,0	5	4,25			
	LK-01-26	100,00	90,0	5	4,50			
	LK-01-27	100,00	90,0	5	4,50			
	LK-01-28	107,12	89,0	5	4,45			
	LK-01-29	107,12	89,0	5	4,45			
	LK-01-30	100,00	90,0	5	4,50			
	LK-01-31	100,00	90,0	5	4,50			
	LK-01-32	115,72	87,0	5	4,35			
	LK-01-33	117,17	87,0	5	4,35			
	LK-01-34	100,00	90,0	5	4,50			
	LK-01-35	100,00	90,0	5	4,50			
	LK-01-36	100,00	90,0	5	4,50			
	LK-01-37	113,22	87,0	5	4,35			
	LK-01-38	113,22	87,0	5	4,35			
	LK-01-39	100,00	90,0	5	4,50			
	LK-01-40	100,00	90,0	5	4,50			
	LK-01-41	125,77	85,0	5	4,25			
	LK-01-42	117,12	87,0	5	4,35			
	LK-01-43	100,00	90,0	5	4,50			
	LK-01-44	100,00	90,0	5	4,50			
	LK-01-45	100,00	90,0	5	4,50			
	LK-01-46	106,78	89,0	5	4,45			
	LK-01-47	106,78	89,0	5	4,45			
	LK-01-48	100,00	90,0	5	4,50			
	LK-01-49	100,00	90,0	5	4,50			
	LK-01-50	125,77	85,0	5	4,25			
	LK-01-51	125,71	85,0	5	4,25			
	LK-01-52	100,00	90,0	5	4,50			
	LK-01-53	100,00	90,0	5	4,50			
	LK-01-54	112,92	87,0	5	4,35			
	LK-01-55	112,92	87,0	5	4,35			
	LK-01-56	100,00	90,0	5	4,50			
	LK-01-57	100,00	90,0	5	4,50			
	LK-01-58	126,40	85,0	5	4,25			
	LK-01-59	125,84	85,0	5	4,25			
	LK-01-60	100,00	90,0	5	4,50			
	LK-01-61	100,00	90,0	5	4,50			
	LK-01-62	107,08	89,0	5	4,45			
	LK-01-63	107,08	89,0	5	4,45			
	LK-01-64	100,00	90,0	5	4,50			
	LK-01-65	100,00	90,0	5	4,50			
	LK-01-66	122,98	85,0	5	4,25			
	LK-2	292,60	24	5	4,20			
	LK-2-01	131,47	84,0	5	4,30			
	LK-2-02	120,00	86,0	5	4,30			
	LK-2-03	120,00	86,0	6	5,16			
	LK-2-04	120,00	86,0	7	6,02			
	LK-2-05	120,00	86,0	8	6,88			
	LK-2-06	120,00	86,0	9	7,74			
	LK-2-07	120,00	86,0	10	8,60			
	LK-2-08	120,00	86,0	11	9,46			
	LK-2-09	120,00	86,0	12	10,32			
	LK-2-10	120,00	86,0	13	11,18			
	LK-2-11	120,00	86,0	14	12,04			
	LK-2-12	120,00	86,0	15	12,90			
	LK-2-13	132,48	84,0	16	13,44			
	LK-2-14	120,00	86,0	17	14,62			
	LK-2-15	120,00	86,0	18	15,48			
	LK-2-16	120,00	86,0	19	16,34			
	LK-2-17	120,00	86,0	20	17,20			
	LK-2-18	120,00	86,0	21	18,06			
	LK-2-19	120,00	86,0	22	18,92			
	LK-2-20	120,00	86,0	23	19,78			
	LK-2-21	120,00	86,0	24	20,64			
	LK-2-22	120,00	86,0	5	4,30			
	LK-2-23	120,00	86,0	5	4,30			
	LK-2-24	130,44	84,0	5	4,20			

STT	Chức năng đất	Ký hiệu	Diện tích (%)	Số lô	MĐXD tối đa (%)	Tầng cao nhất	Hệ số sử dụng đất	Tỷ lệ (%)
	Đất ở liên kết 3	LK-3	2635,52	21	5	4,15		
	LK-3-01	133,45	83,0	5	4,15			
	LK-3-02	120,00	86,0	5	4,30			
	LK-3-03	120,00	86,0	5	4,30			
	LK-3-04	120,00	86,0	5	4,30			
	LK-3-05	120,00	86,0	5	4,30			
	LK-3-06	120,00	86,0	5	4,30			
	LK-3-07	120,00	86,0	5	4,30			
	LK-3-08	120,00	86,0	5	4,30			
	LK-3-09	120,00	86,0	5	4,30			
	LK-3-10	120,00	86,0	5	4,30			
	LK-3-11	120,00	86,0	5	4,30			
	LK-3-12	153,10	79,0	5	3,95			
	LK-3-13	136,00	83,0	5	4,15			
	LK-3-14	120,00	86,0	5	4,30			
	LK-3-15	120,00	86,0	5	4,30			
	LK-3-16	120,00	86,0	5	4,30			
	LK-3-17	120,00	86,0	5	4,30			
	LK-3-18	120,00	86,0	5	4,30			
	LK-3-19	120,00	86,0	5	4,30			
	LK-3-20	120,00	86,0	5	4,30			
	LK-3-21	170,97	76,0	5	3,80			
1.2	Đất ở biệt thự	BT	4307,91	16	3	1,77		10,56
	BT-01	318,88	59,0	3	1,77			
	BT-02	261,29	64,0	3	1,92			
	BT-03	276,04	62,0	3	1,86			
	BT-04	270,71	63,0	3	1,89			
	BT-05	270,79	63,0	3	1,89			
	BT-06	276,26	62,0	3	1,86			
	BT-07	261,63	64,0	3	1,92			
	BT-08	312,81	59,0	3	1,77			
	BT-09	301,11	60,0	3	1,80			
	BT-10	246,70	65,0	3	1,95			
	BT-11	247,64	65,0	3	1,95			
	BT-12	235,76	66,0	3	1,98			
	BT-13	235,39	66,0	3	1,98			
	BT-14	246,59	65,0	3	1,95			
	BT-15	245,25	65,0	3	1,95			
	BT-16	301,04	60,0	3	1,80			
2	Đất cây xanh, sân chơi	CX	1006,56	1				2,42
	Đất cây xanh, sân chơi	CX	1006,56					
3	Đất bãi xe công cộng	P	1248,00	2				3,00
	Đất bãi xe công cộng 1	P1	629,20					
	Đất bãi xe công cộng 2	P2	618,80					
4	Đất sử dụng nước thải	HTKT	342,88	1	40	1	0,40	0,82
	Đất sử dụng nước thải + cách ly	HTKT	342,88		40	1	0,40	0,82
5	Đất giao thông		21971,37					55,82
	Đất đường giao thông + vỉa hè P1		21971,37					
TỔNG ĐẤT QUY HOẠCH			41595,36					100,00

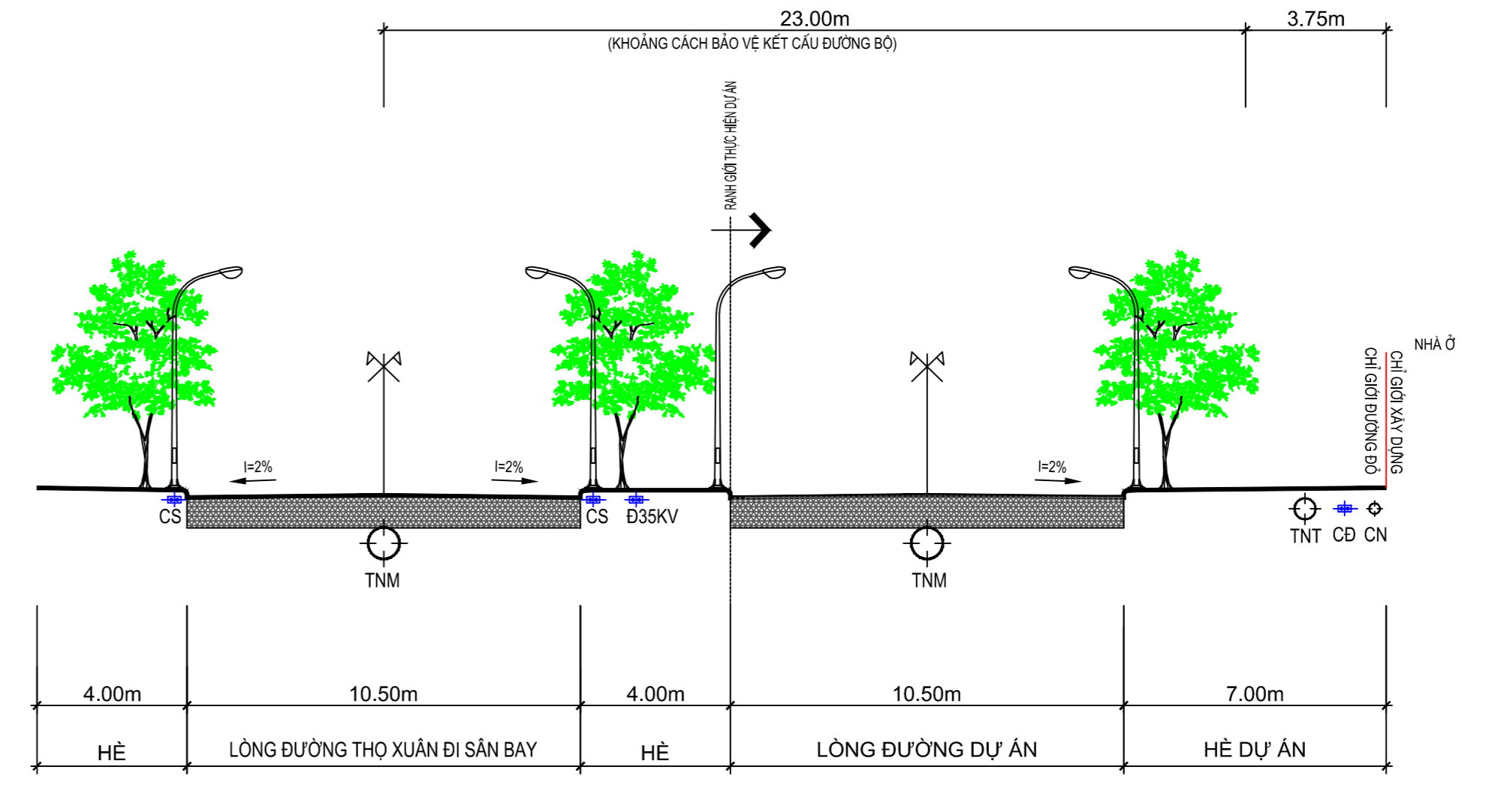
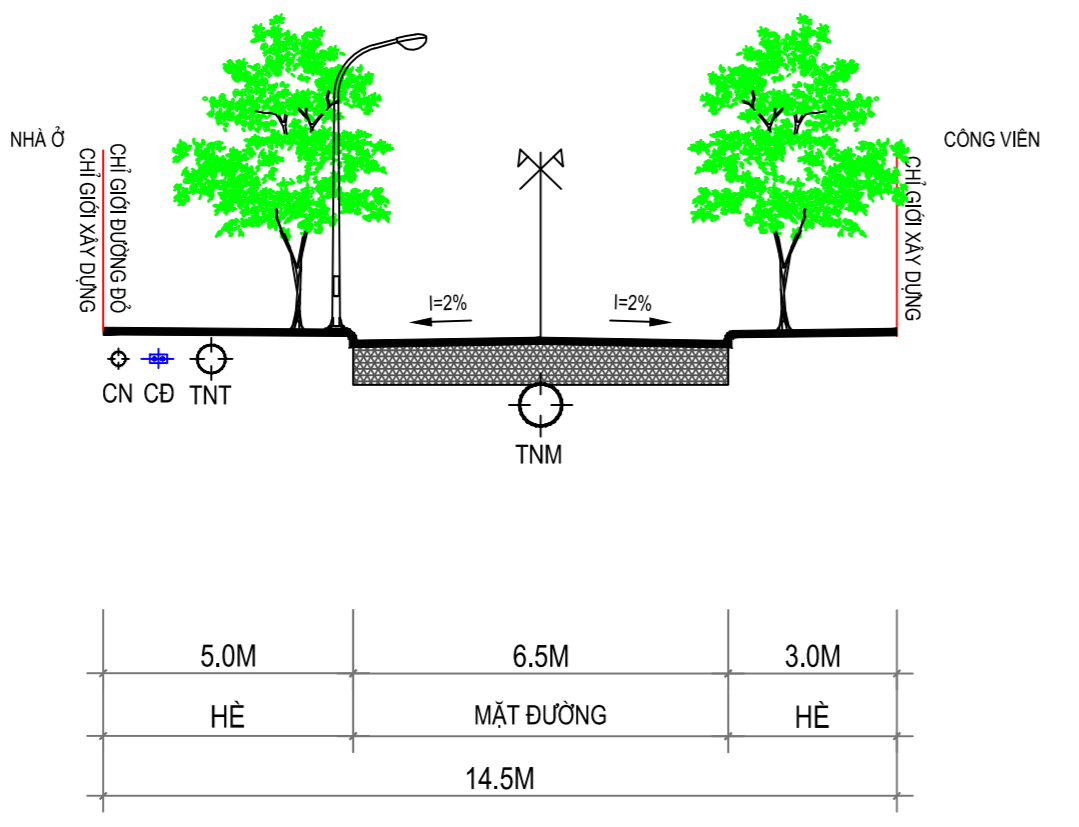
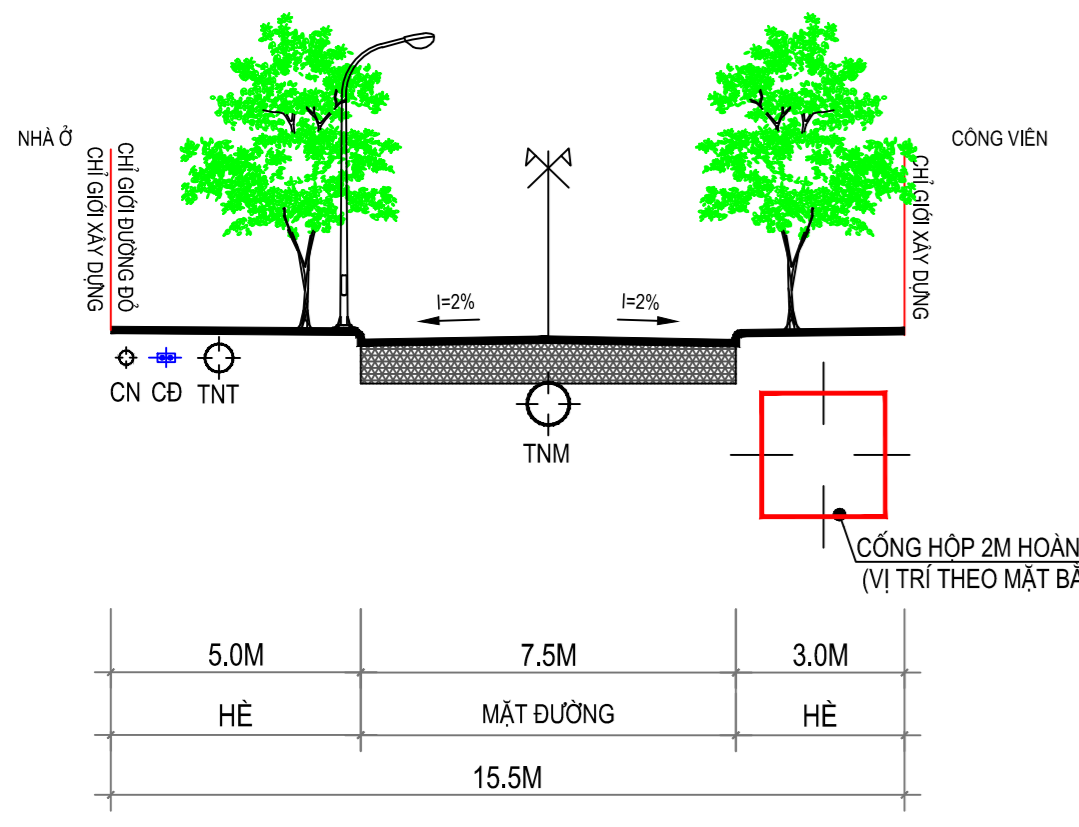
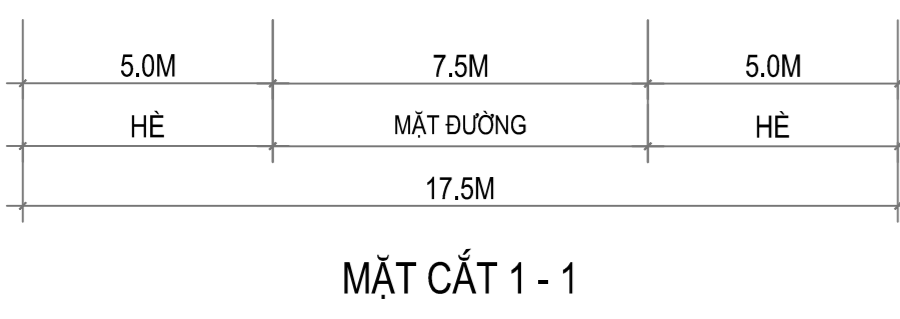
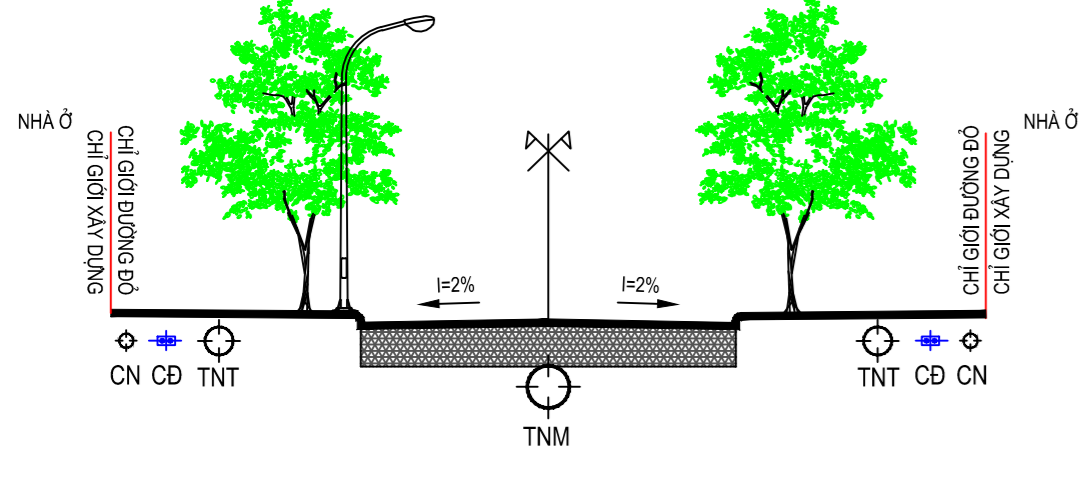
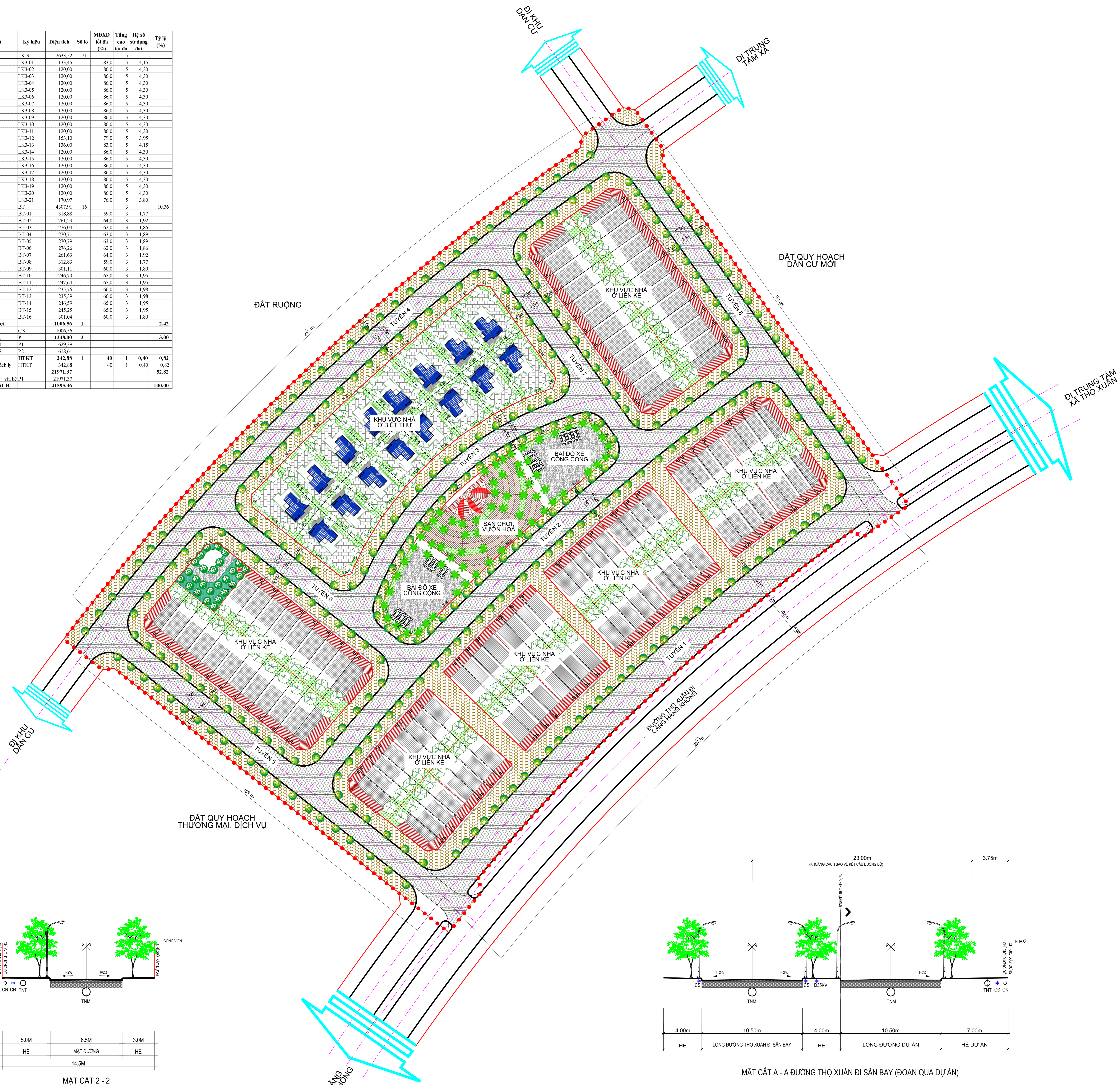
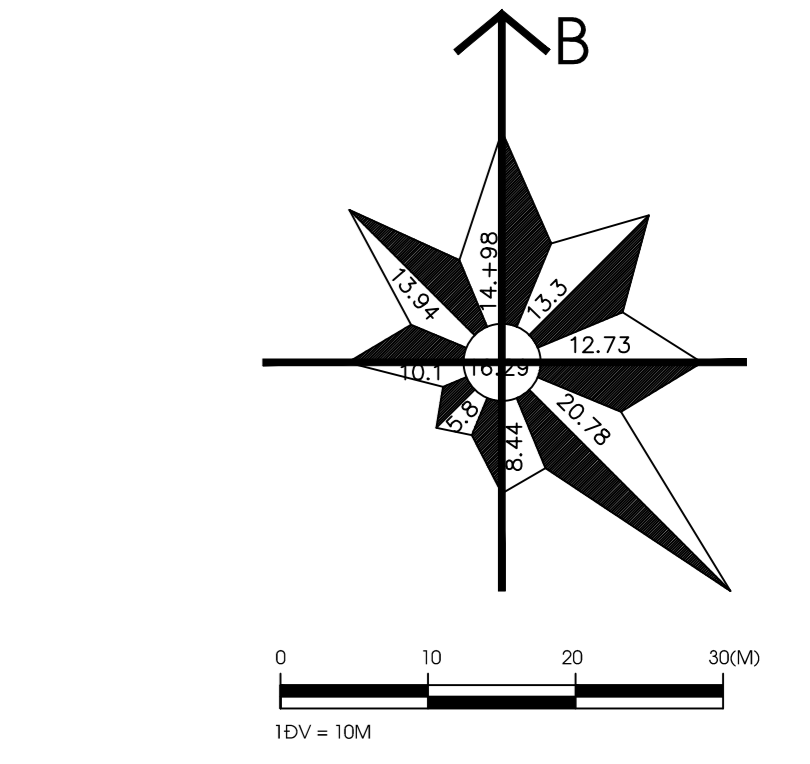

CƠ QUAN PHÉ DUYỆT
 ỦY BAN NHÂN DÂN XÃ THỌ XU